

1736

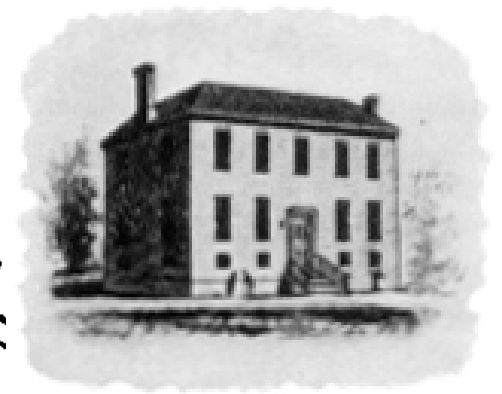

The First Poorhouse in New-York, 1736.

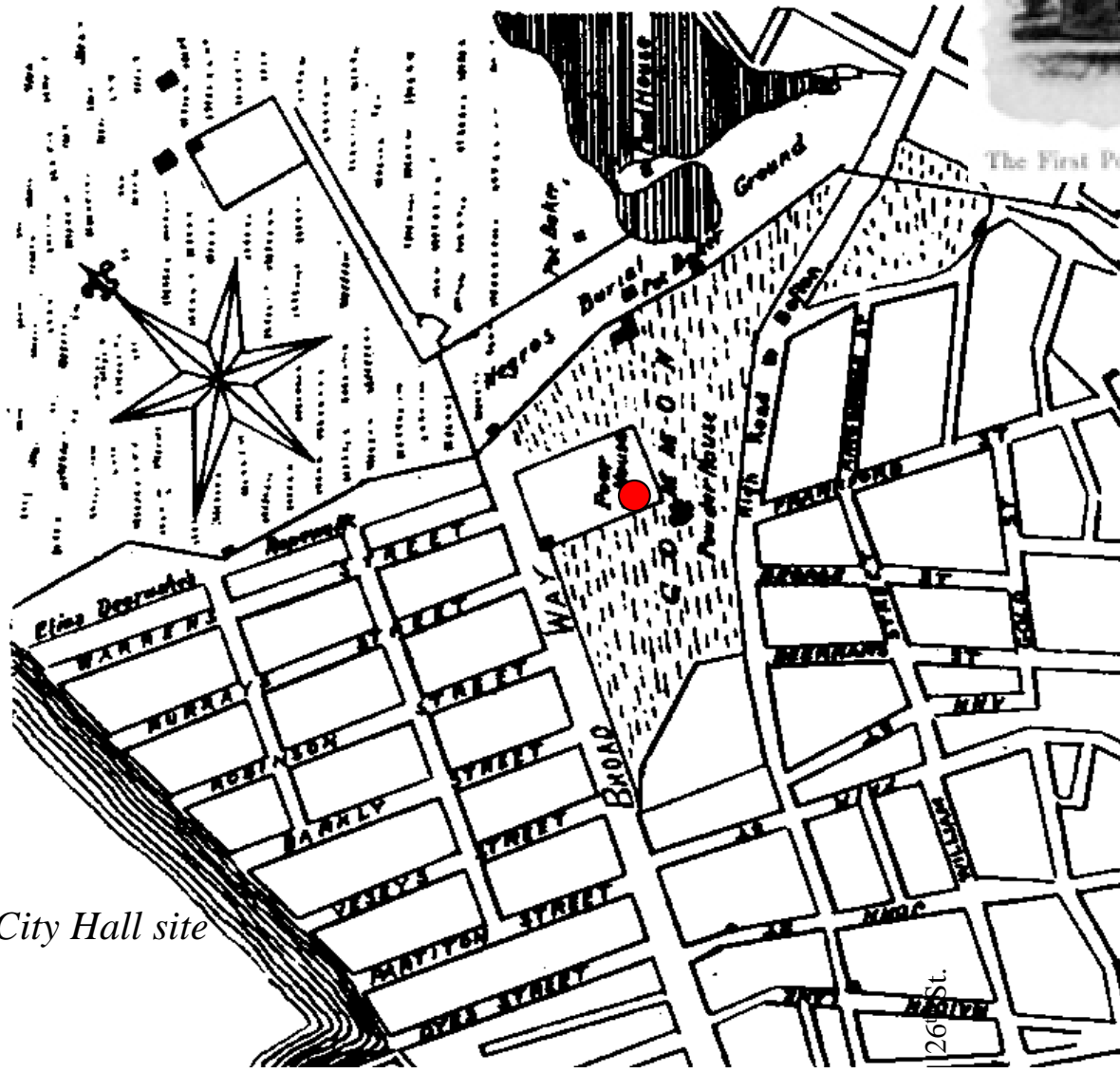

*Almshouse on City Hall site*

1816

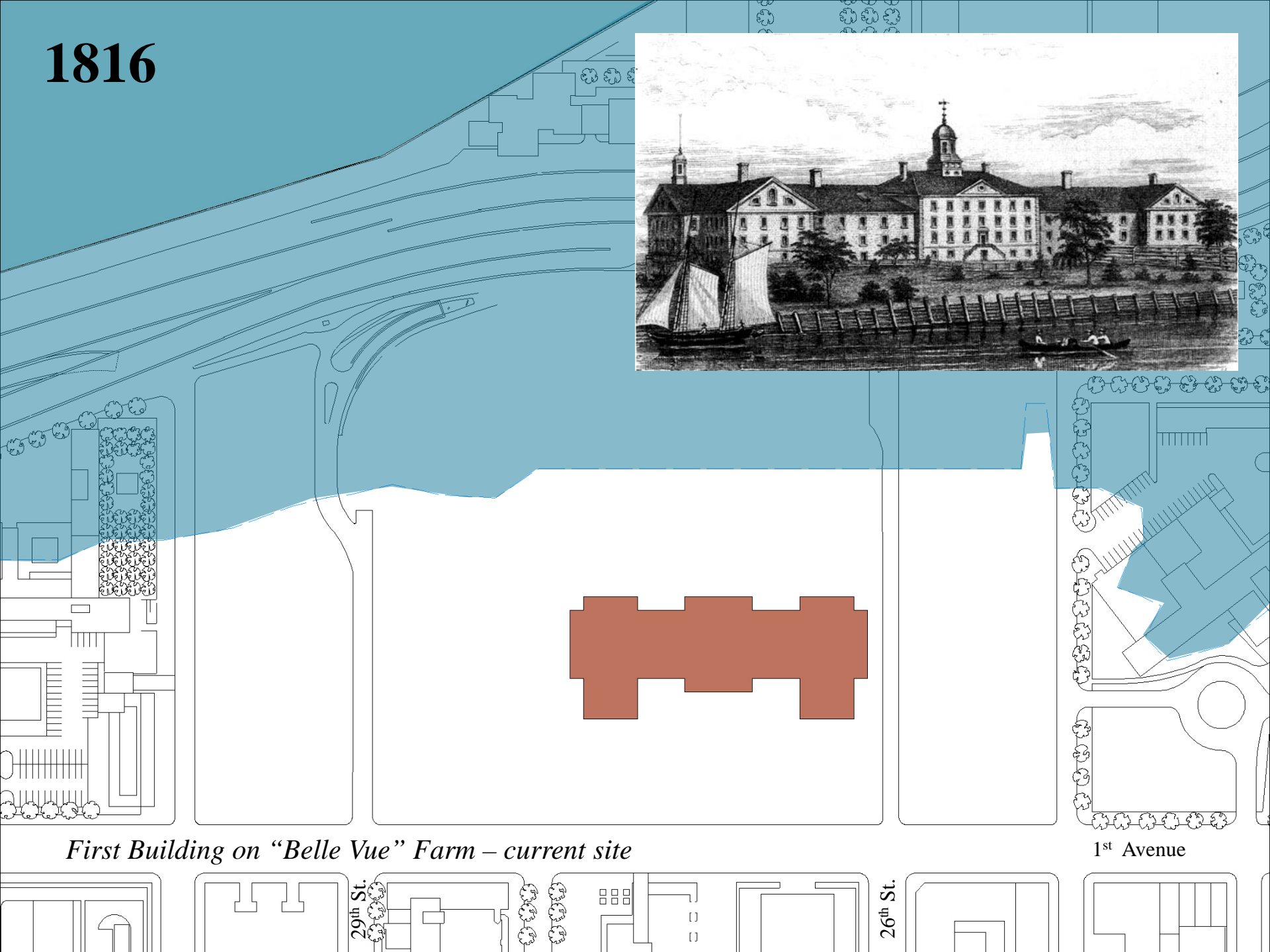
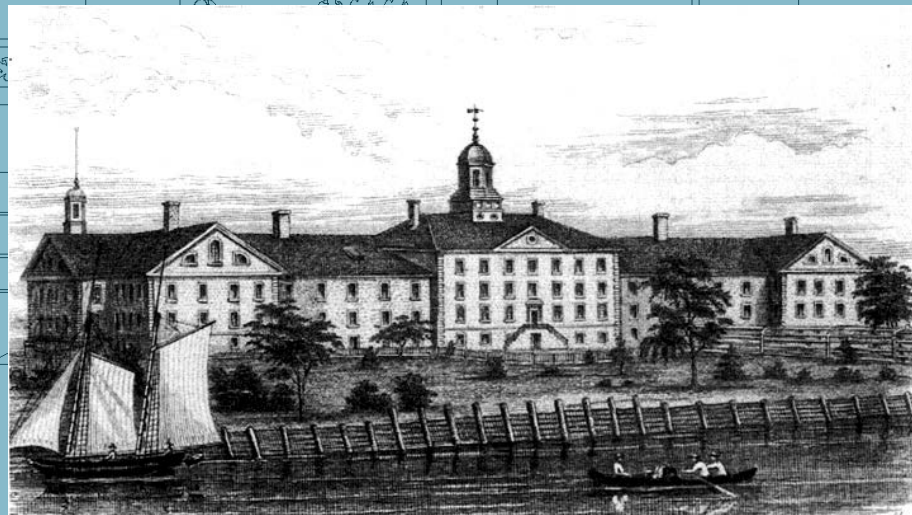

*First Building on "Belle Vue" Farm – current site*

1<sup>st</sup> Avenue

29<sup>th</sup> St.

26<sup>th</sup> St.

1864

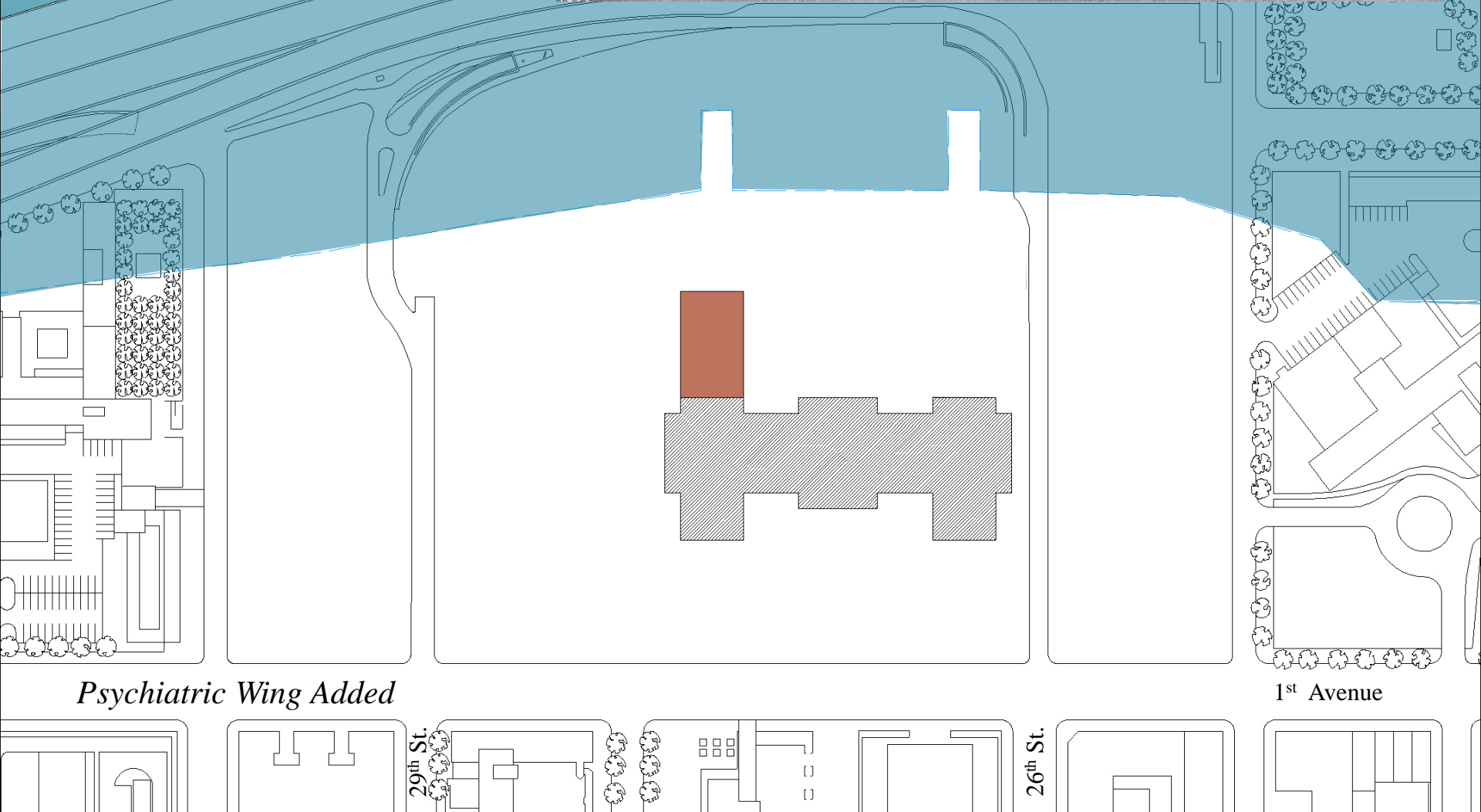

*Psychiatric Wing Added*

1<sup>st</sup> Avenue

29<sup>th</sup> St.

26<sup>th</sup> St.

1869

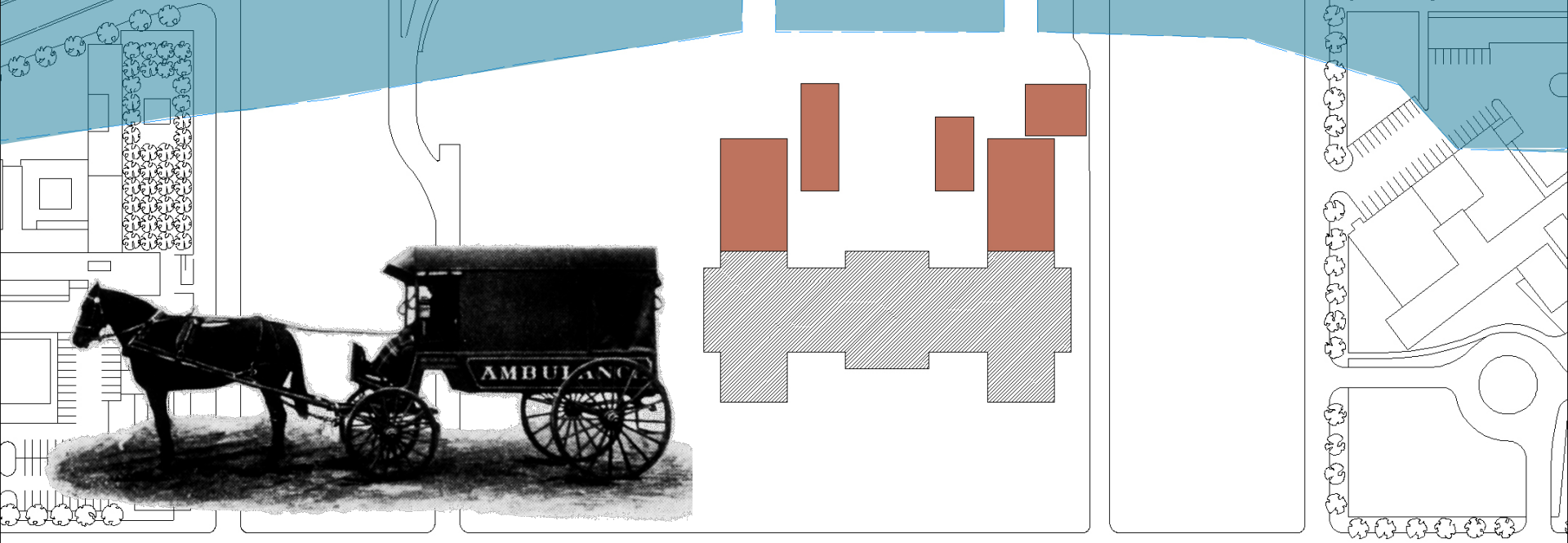

*Further Additions & First Ambulance Service*

1<sup>st</sup> Avenue

29<sup>th</sup> St.

26<sup>th</sup> St.



1895

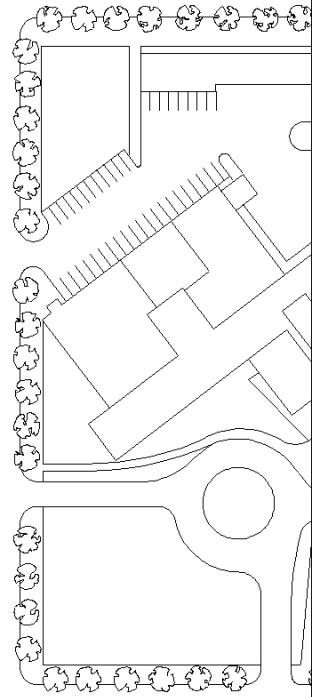
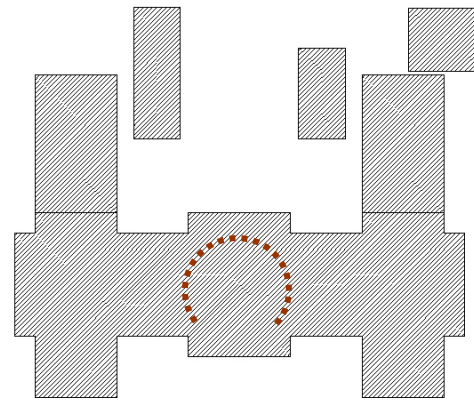
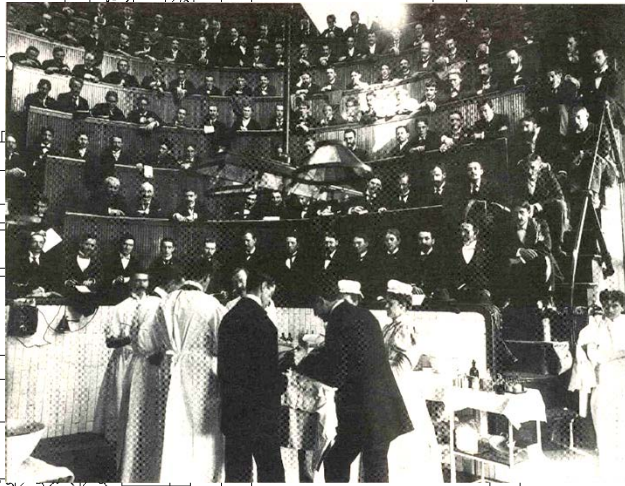

*New Operating Theatre*

1<sup>st</sup> Avenue

29<sup>th</sup> St.

26<sup>th</sup> St.

1903

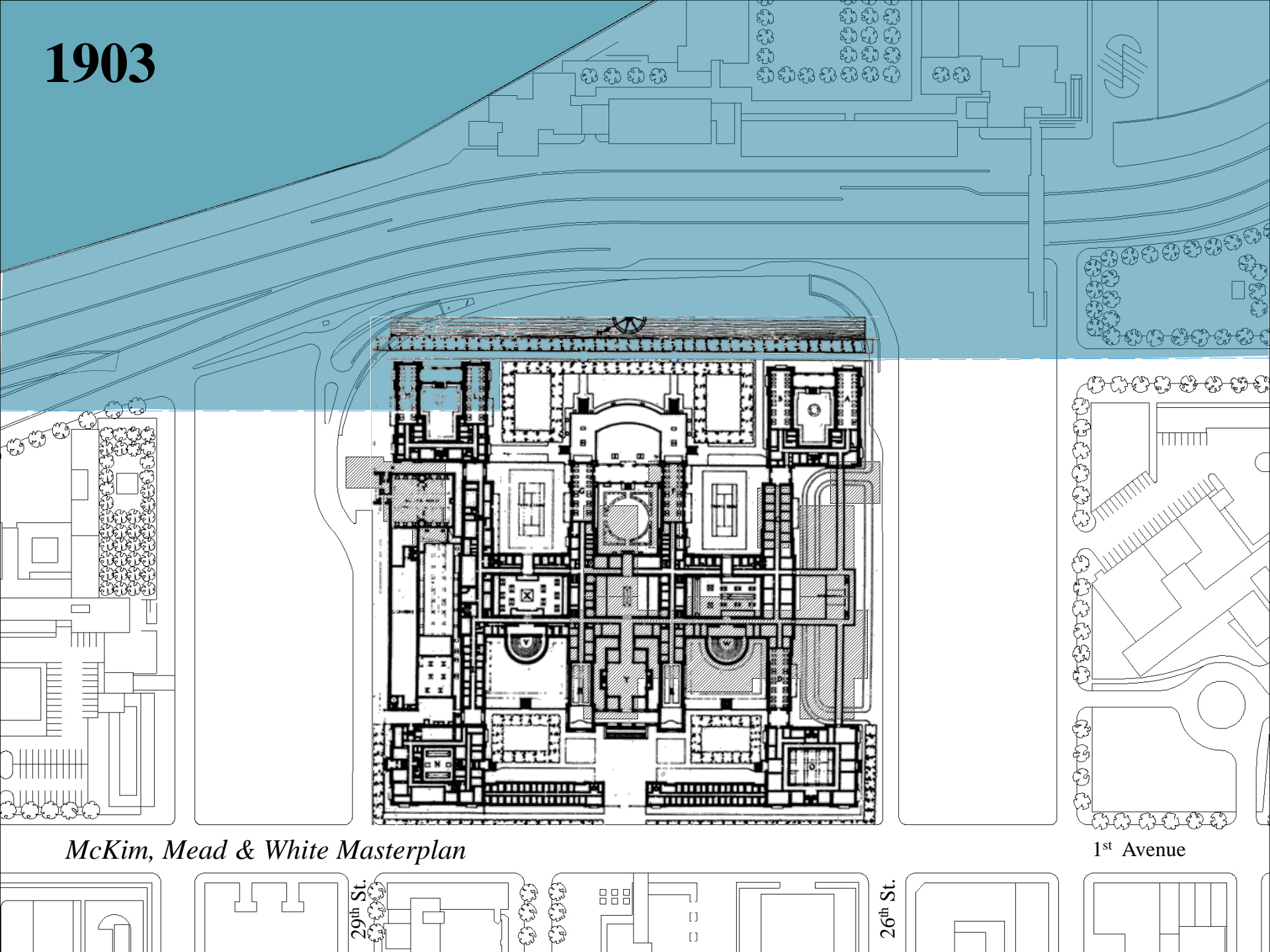

*McKim, Mead & White Masterplan*

1<sup>st</sup> Avenue

29<sup>th</sup> St.

26<sup>th</sup> St.



1903

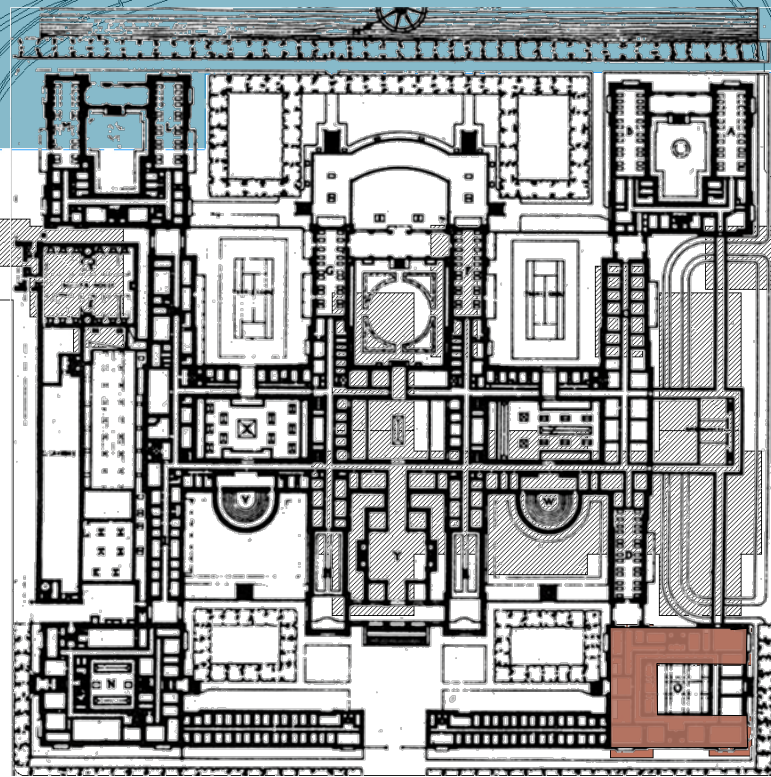

*First Building (Outpatients) of Masterplan Realized*

1<sup>st</sup> Avenue

29<sup>th</sup> St.

26<sup>th</sup> St.

1908

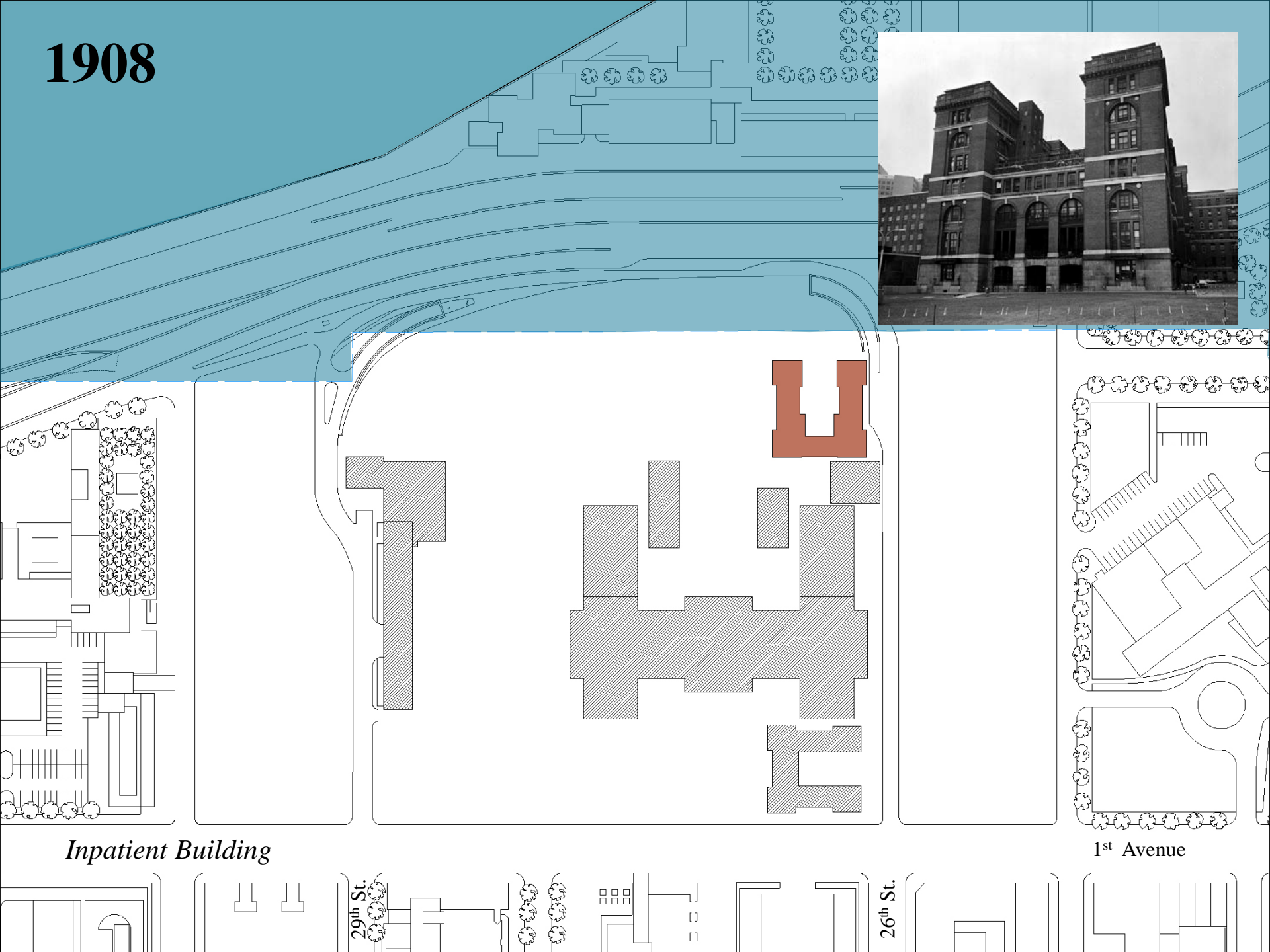

*Inpatient Building*

1<sup>st</sup> Avenue

29<sup>th</sup> St.

26<sup>th</sup> St.



1915



*Surgery Pavilion & End of Horse-drawn Ambulance Service*

1<sup>st</sup> Avenue

29<sup>th</sup> St.

26<sup>th</sup> St.

1918



*Residential & Laboratory Pavilions*

1<sup>st</sup> Avenue

29<sup>th</sup> St.

26<sup>th</sup> St.

# 1918

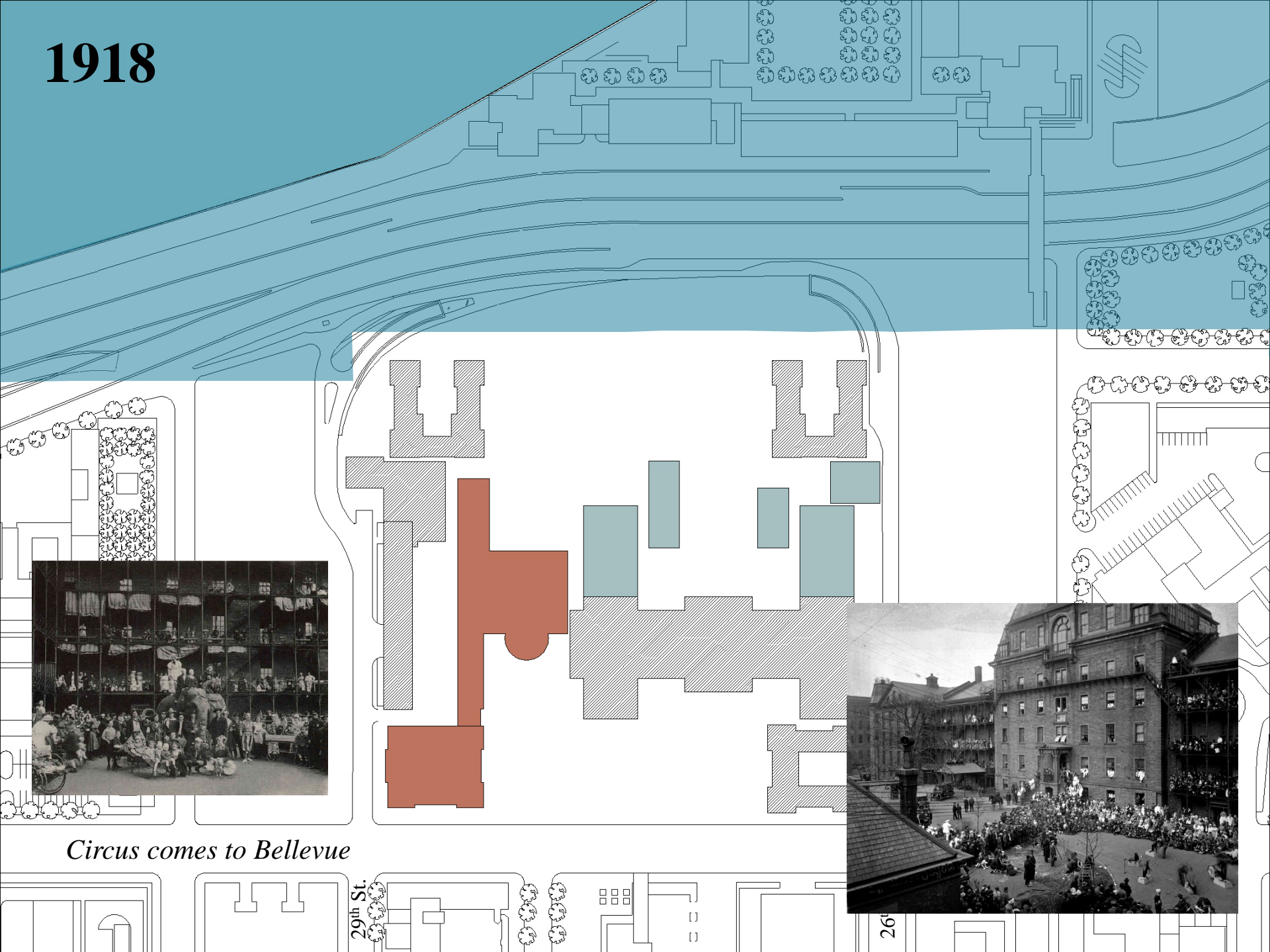

*Circus comes to Bellevue*





1926

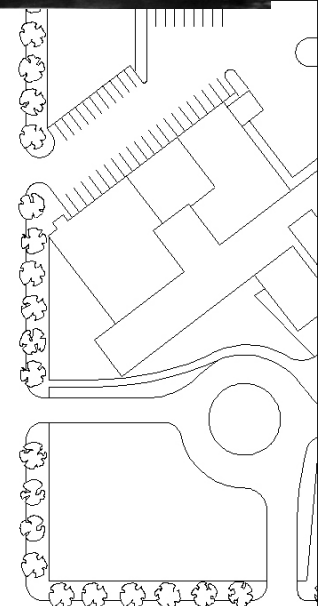
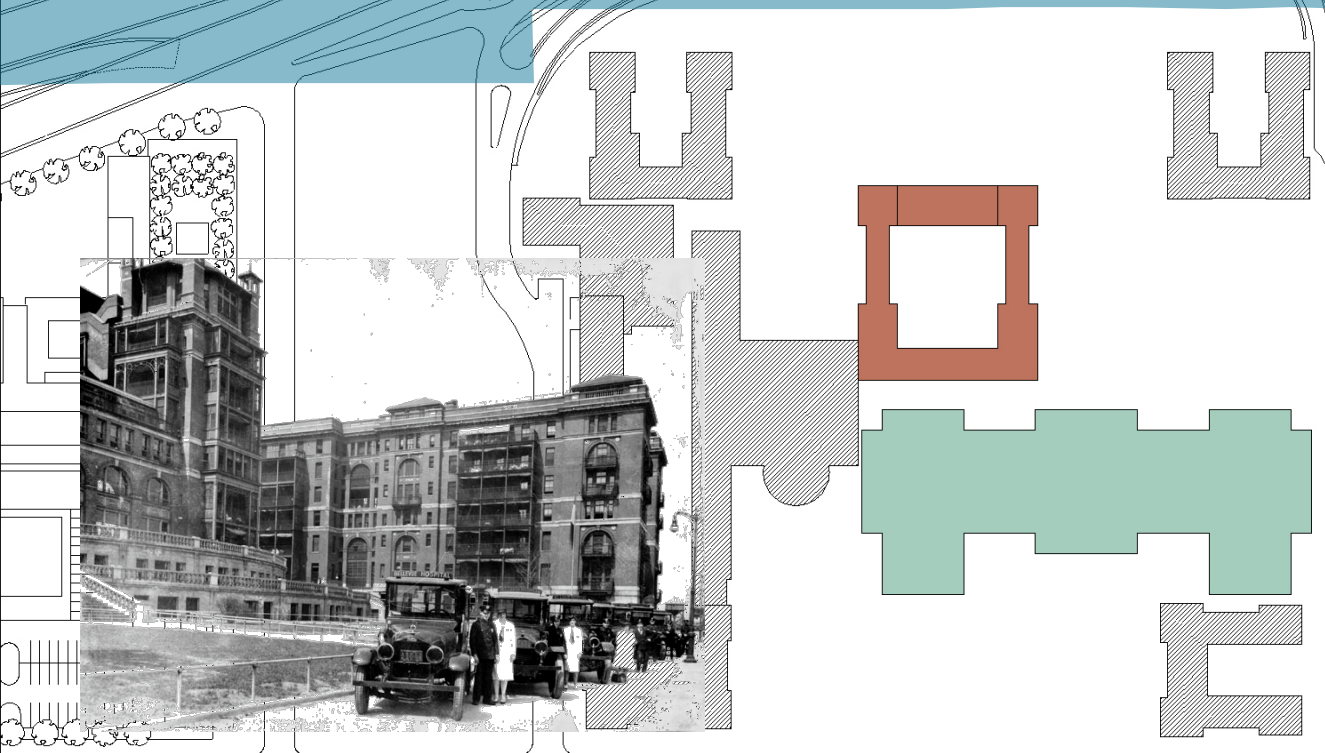

*In-patient & Pediatrics Pavilion & Motorized Ambulance Service*

1st Avenue

29th St.

26th St.



1926

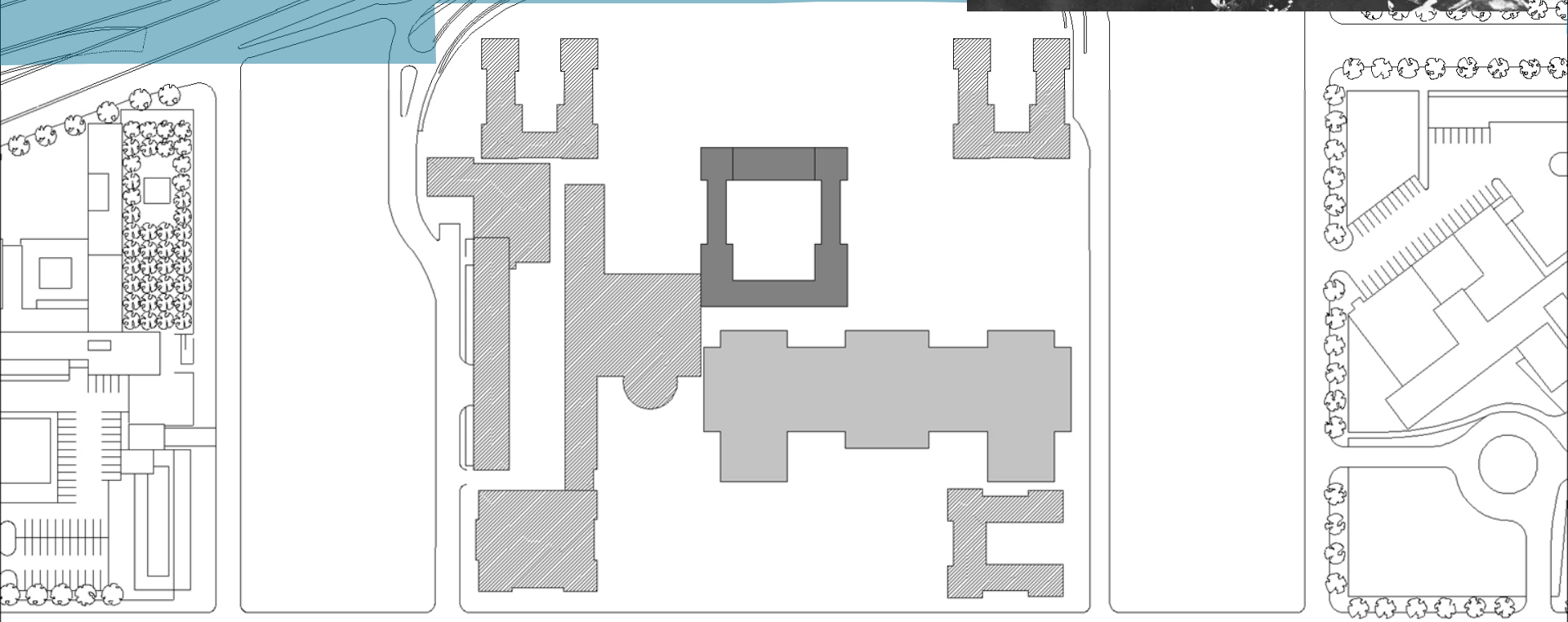

*Phase I Masterplan Complete*

1<sup>st</sup> Avenue

29<sup>th</sup> St.

26<sup>th</sup> St.

1926

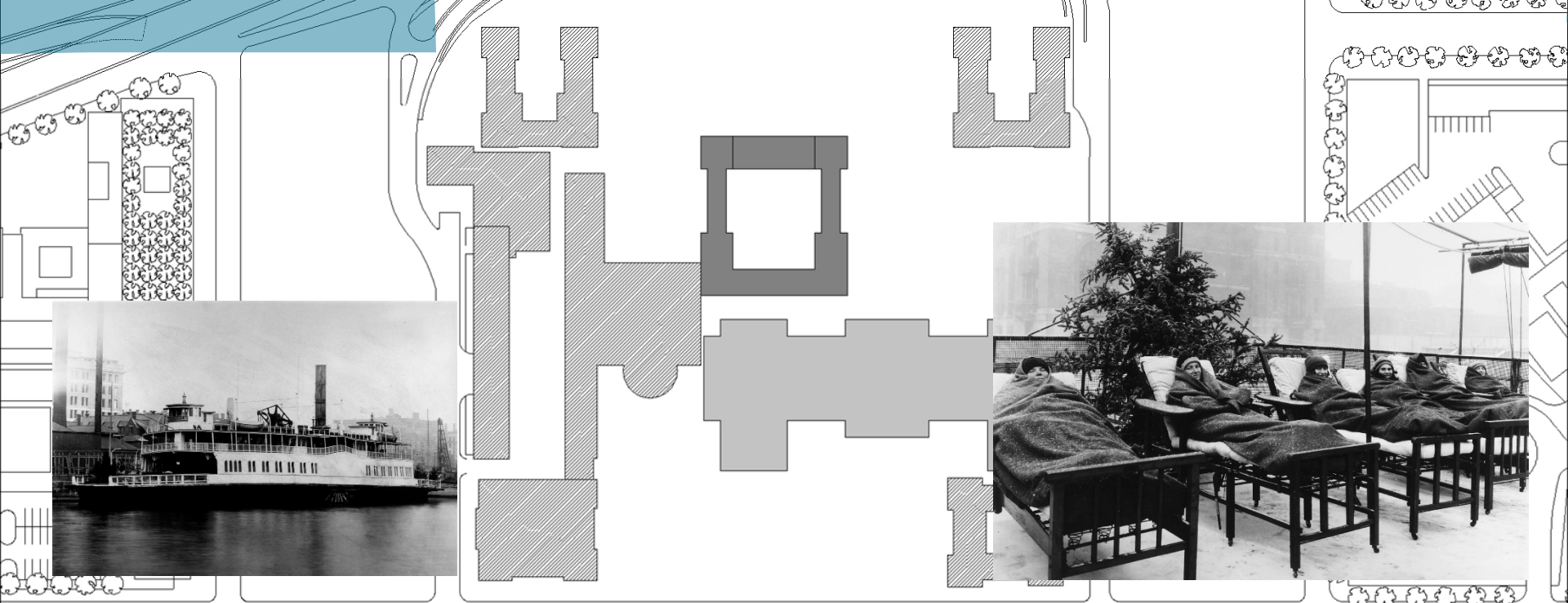
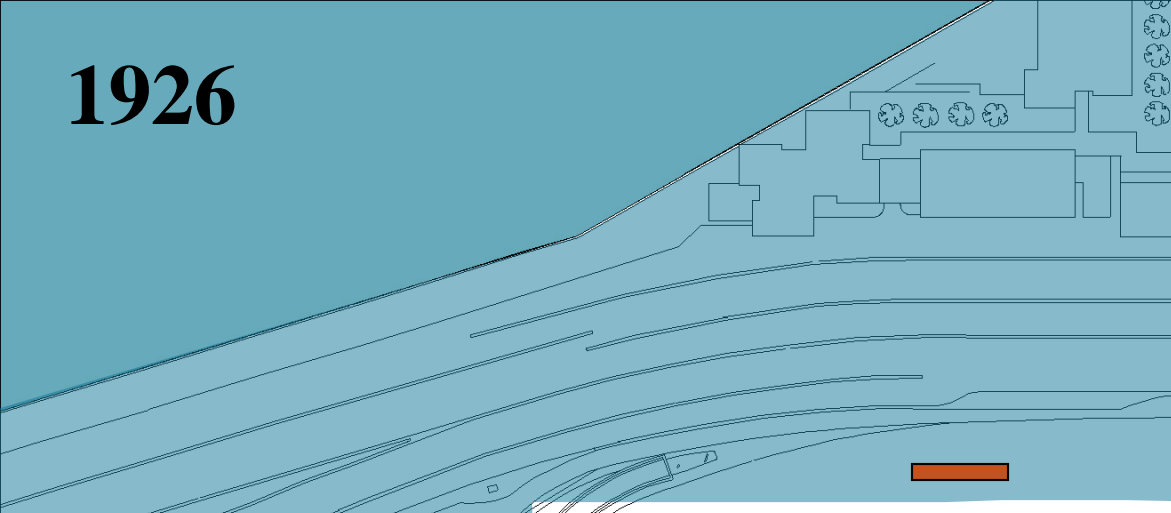

*TB Ferry on East River*



1<sup>st</sup> Avenue

29<sup>th</sup> St.

26<sup>th</sup> St.

1938

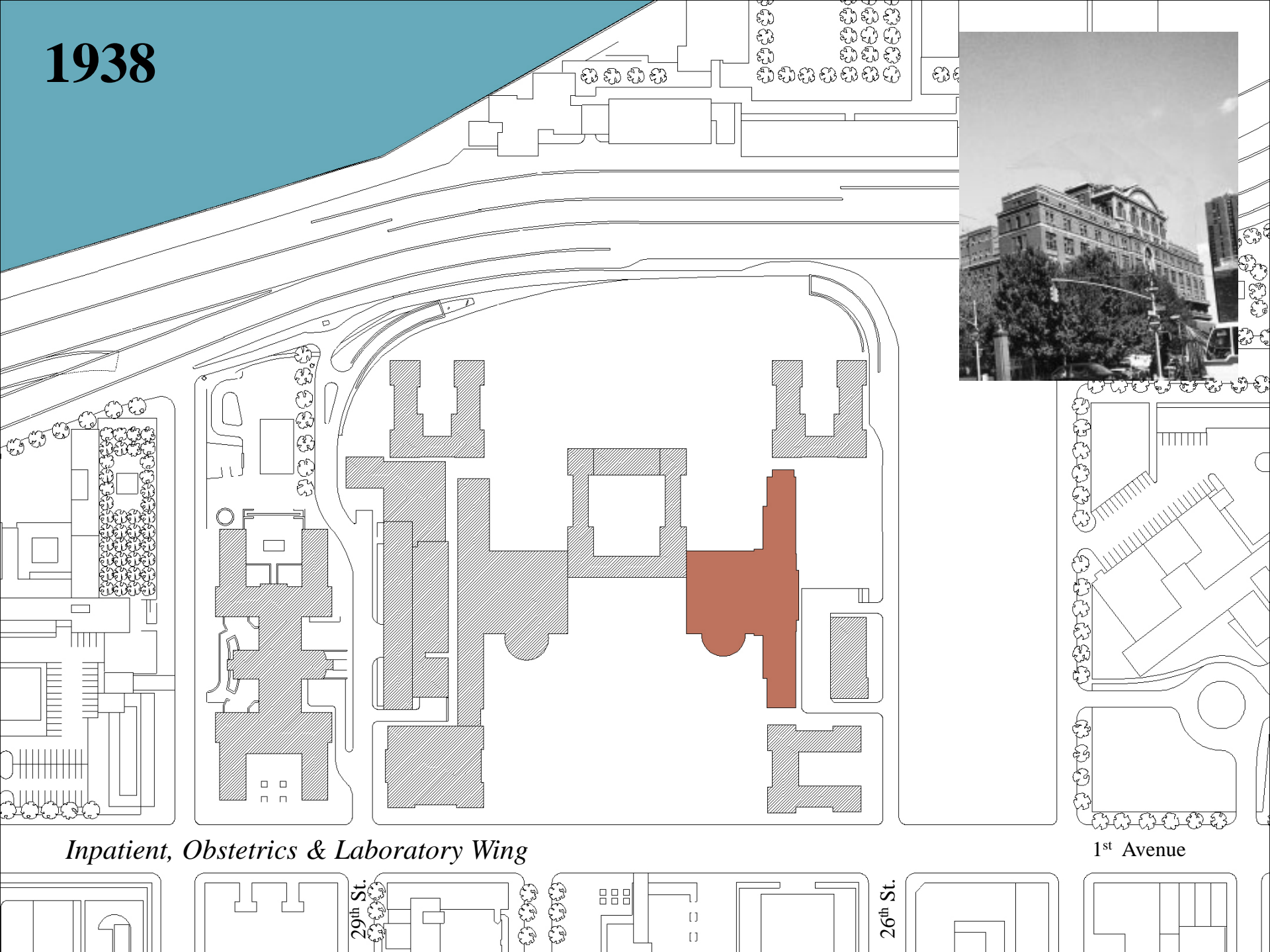

*Inpatient, Obstetrics & Laboratory Wing*

1st Avenue

29th St.

26th St.



1940

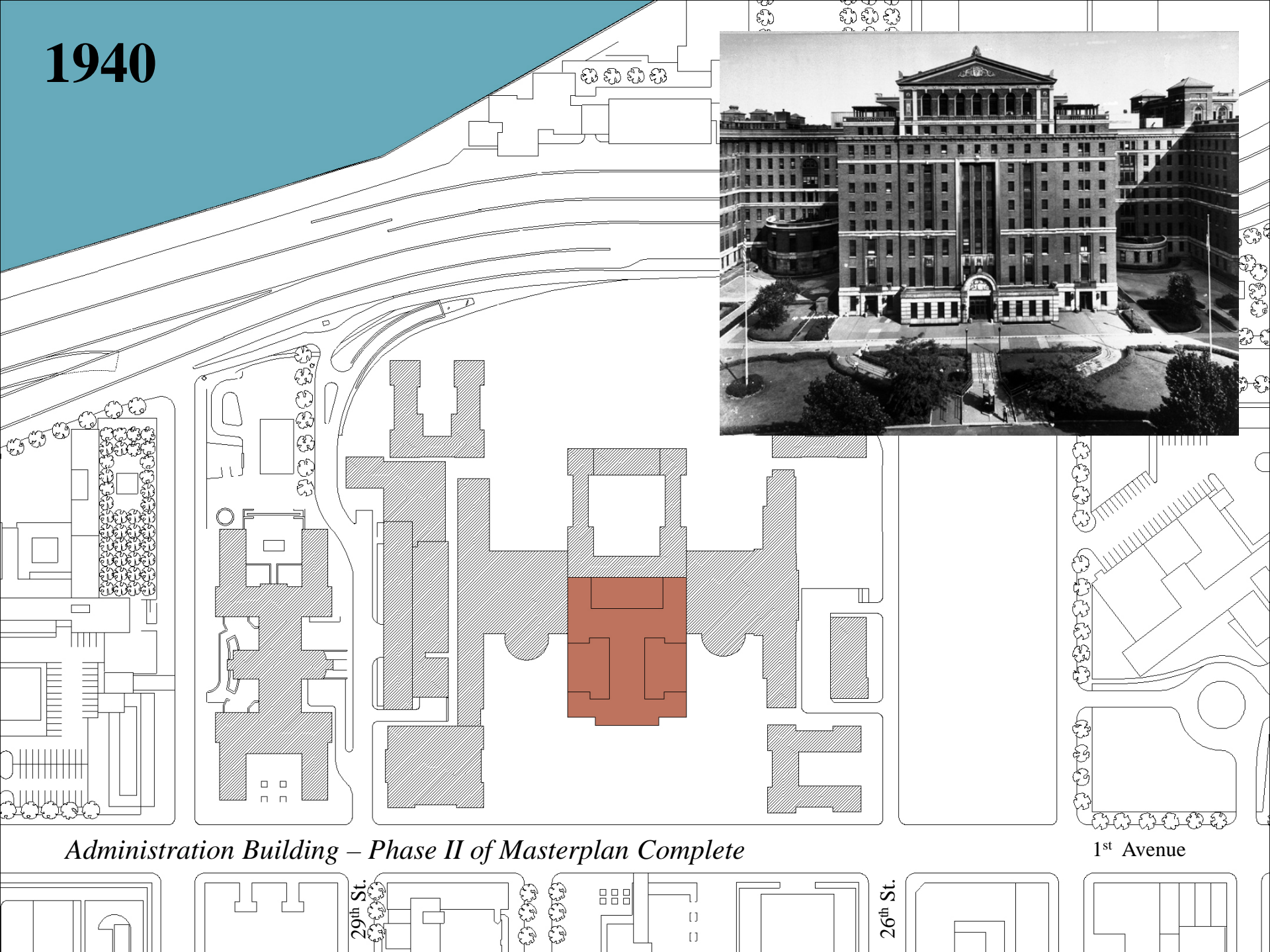

*Administration Building – Phase II of Masterplan Complete*

1st Avenue

29th St.

26th St.



1962

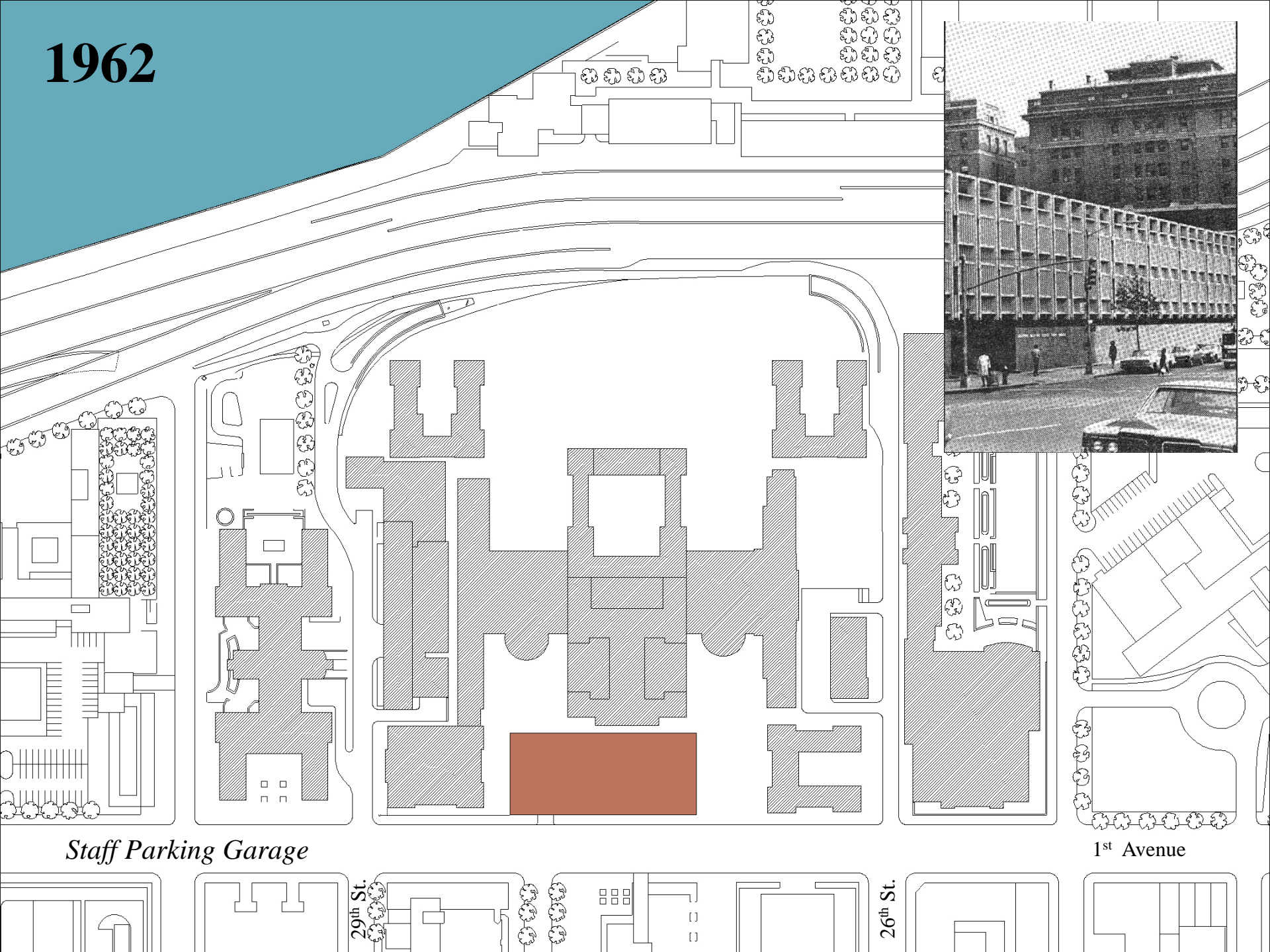

*Staff Parking Garage*

1st Avenue

29th St.

26th St.

1968

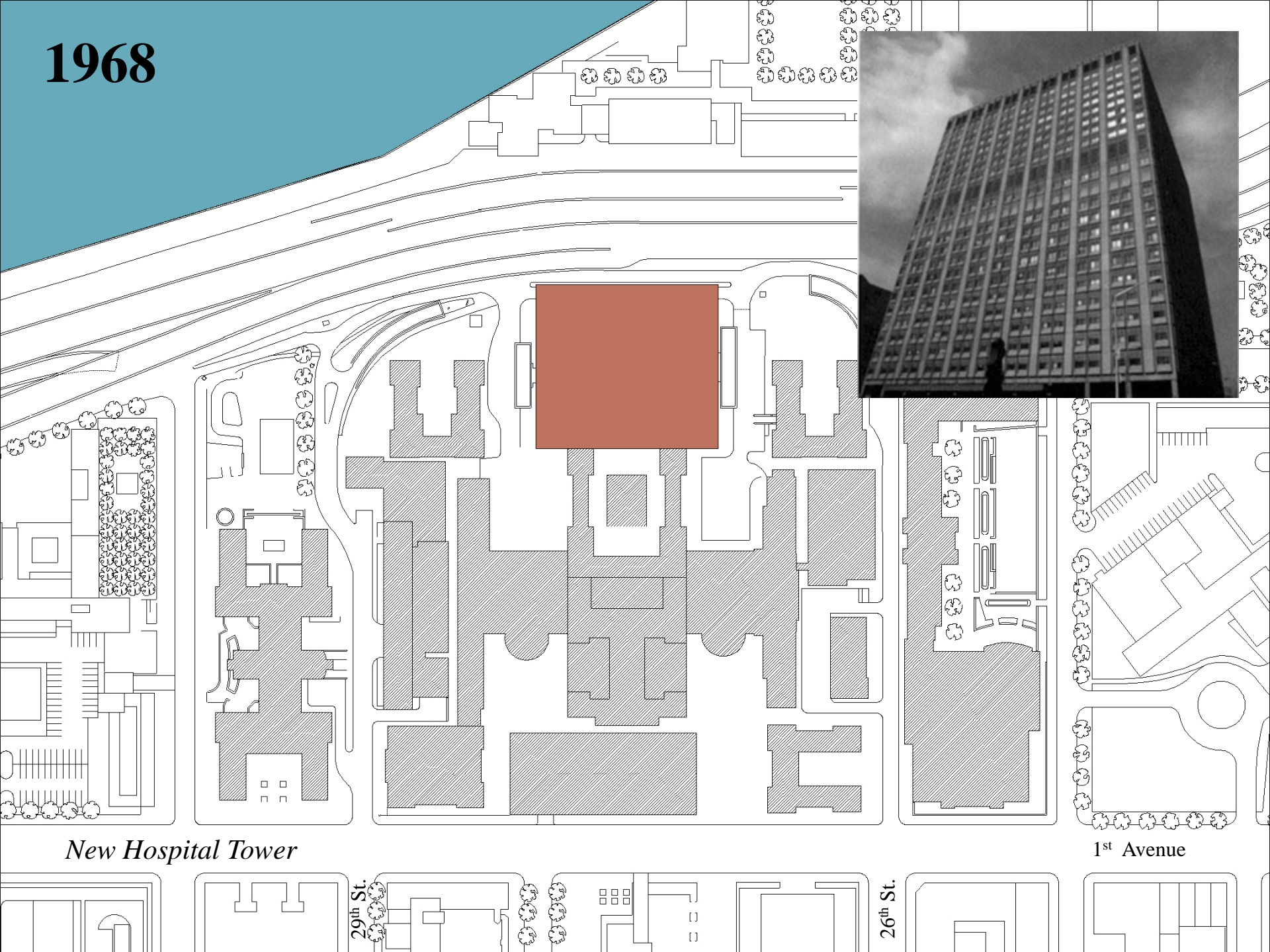

*New Hospital Tower*

1<sup>st</sup> Avenue

29<sup>th</sup> St.

26<sup>th</sup> St.

1974



*Demolition*

1st Avenue

29th St.

26th St.



1978

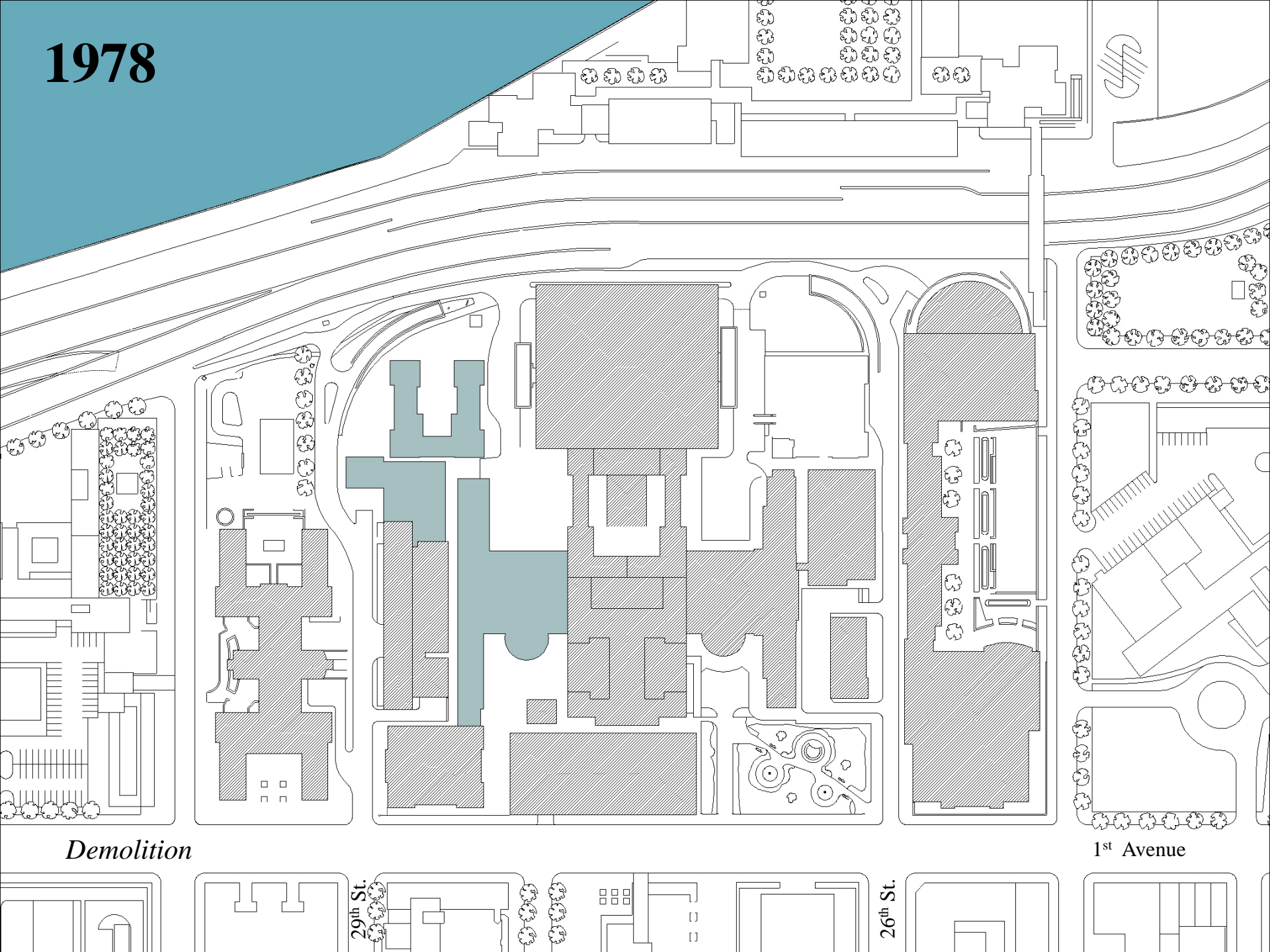

*Demolition*

1<sup>st</sup> Avenue

29<sup>th</sup> St.

26<sup>th</sup> St.



1981

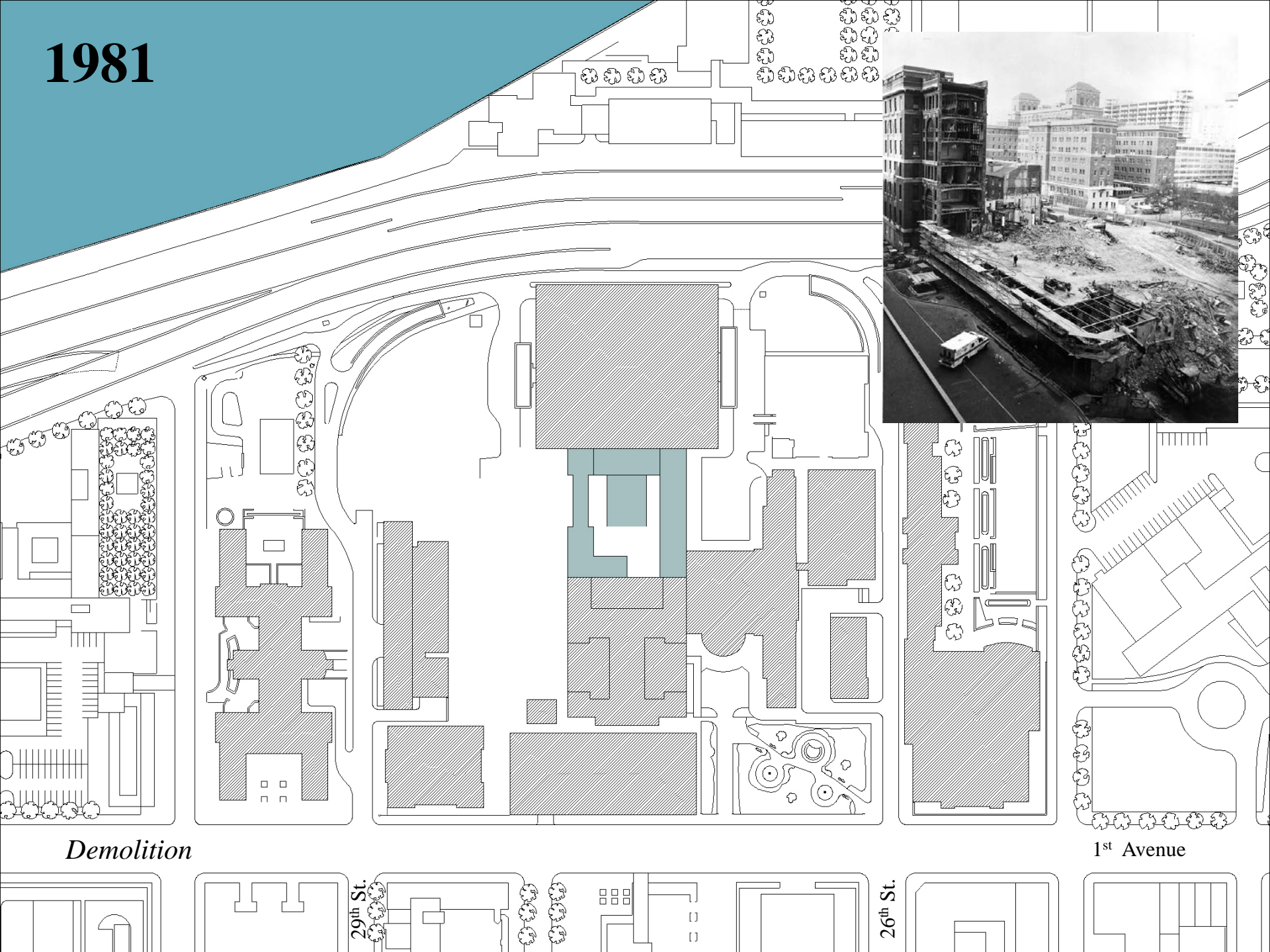

*Demolition*

1<sup>st</sup> Avenue

29<sup>th</sup> St.

26<sup>th</sup> St.

1998



*New Emergency Room*

29th St.

26th St.

1st Avenue

2001

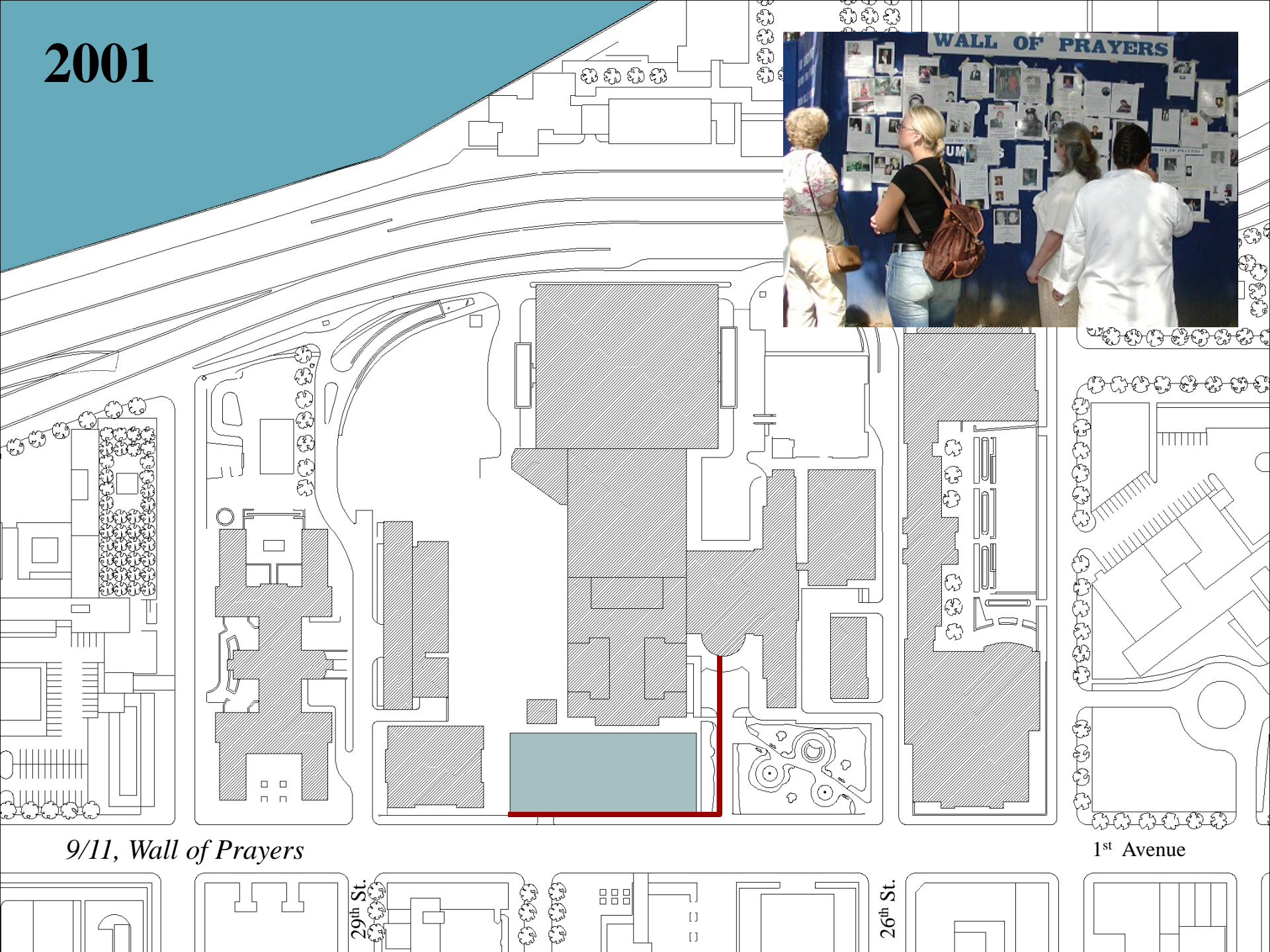

*9/11, Wall of Prayers*

1st Avenue

29th St.

26th St.



2005



*New Ambulatory Pavilion and Entrance*

1<sup>st</sup> Avenue

29<sup>th</sup> St.

26<sup>th</sup> St.

2005

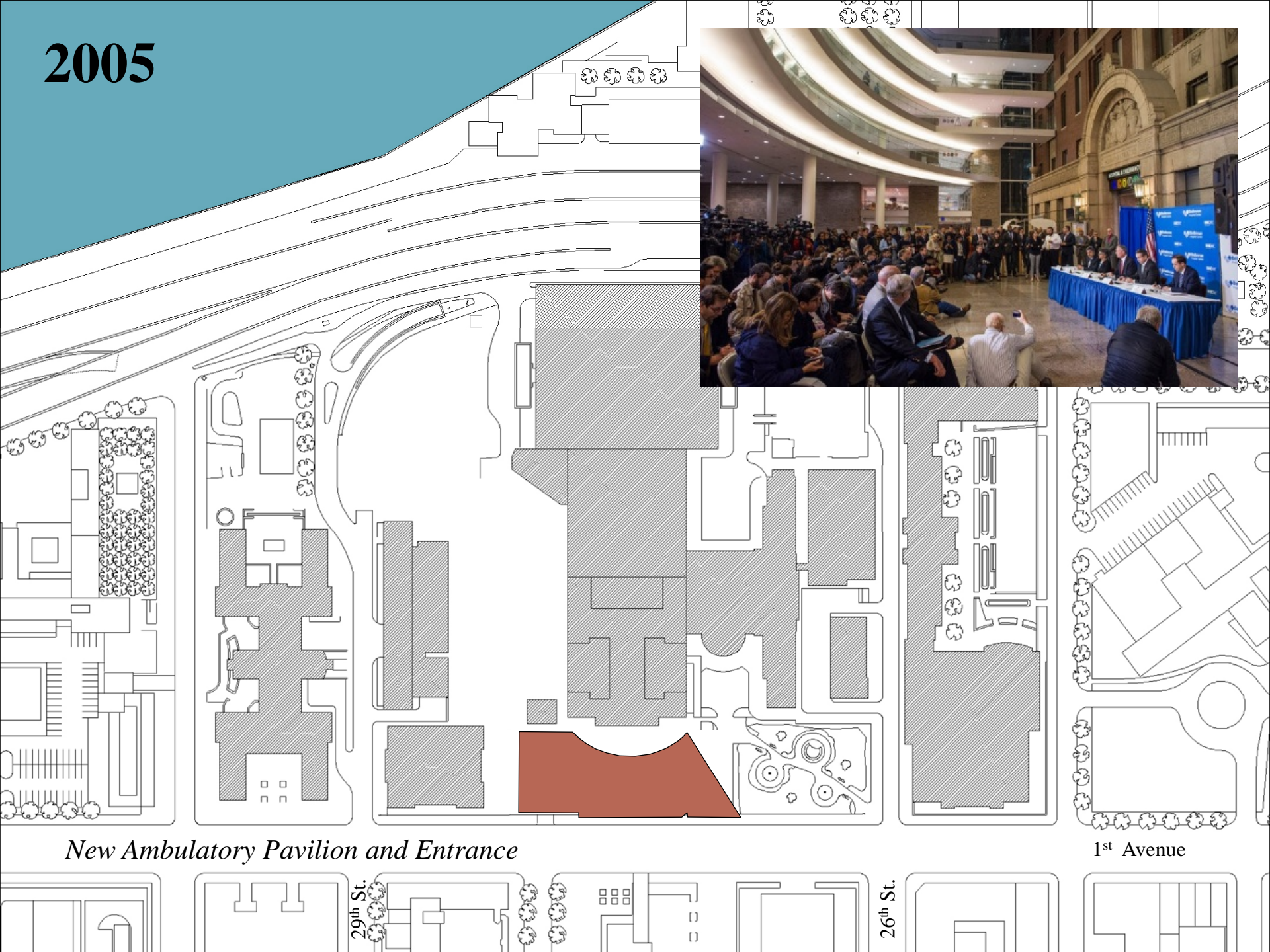

*New Ambulatory Pavilion and Entrance*

1<sup>st</sup> Avenue

29<sup>th</sup> St.

26<sup>th</sup> St.